



CAPITOL THEATRE RENOVATION

Megan Schaafsma
04/19/2024

Concept

Lotus Flower - Perseverance

The Capitol theatre has shown time and time again a strong push, and determination to keep its magic alive. From threats of demolition in 1989 to filing for bankruptcy in 2007, the community persevered and continued to fight. Now moving into 2024 this beautiful theatre celebrates its 104th birthday with many more to come thanks to the support and values of the community that surrounds it. To see this new, found stability through many years of struggles, that is true perseverance.

The lotus flower symbolizes perseverance as its life starts rooted in mud and slowly grows through the muck, resulting in a beautiful flower that sits gently above the water. Even against strong winds and rains, lotus flowers flourish, so they're seen as an emblem of hope and resilience. I aim to speak volumes using this concept through the choice of powerful colours, structure, in combination with elements of movement to best represent the continuous push and steps taken to keep the Capitol Theatre alive.



Mood Board

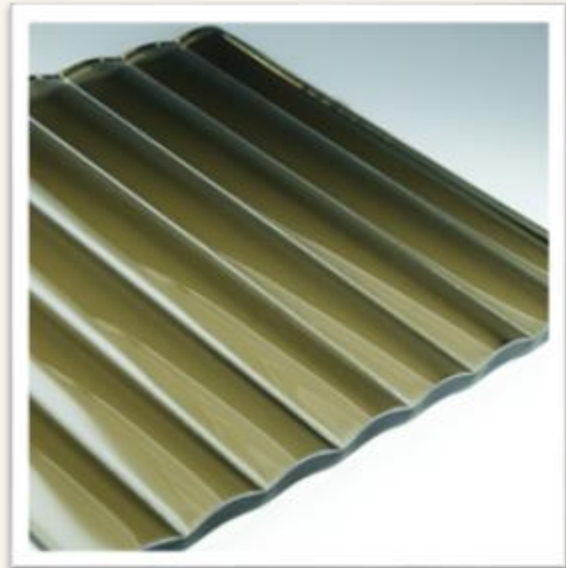
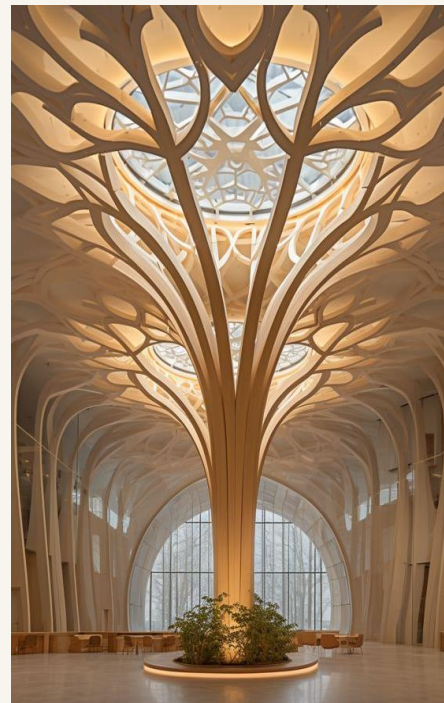

Main Floor – Furniture Plan

General notes

- Main changes made to fix circulation issues and occupancy load requirements
- Women's washrooms have been construction larger to make room for addition stalls
- Many new doorways and openings have been implemented to ensure better circulation and a more fluid means of egress for occupants
- This include the two new 8' doorways added onto either side of the lobby
- In the new design there are now 2 main permanent bar areas located in the lounge and joy theatre and a small secondary bar in the art gallery to encourage occupants to grab a drink and roam the art cite or lounge on one of the many seating options

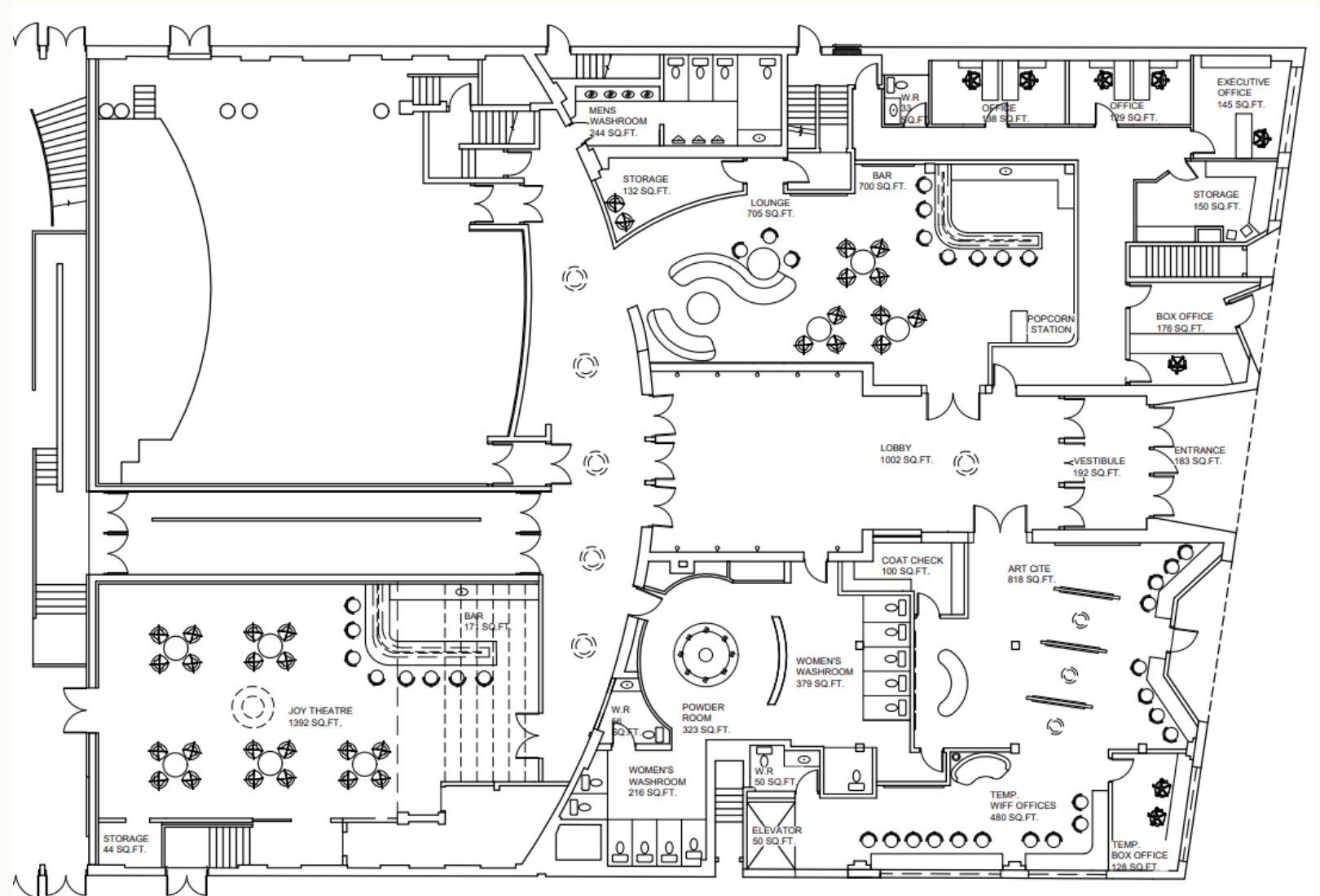

Exterior Signage

General Notes

- Enlarge signage
- Previous signage was hidden – new signage allows for maximal visibility to public
- Incorporation of lotus outline to tie into concept
- Better use of canopy face

CAPITOL

Side Signage

- Modern enhancements to original signage
- Cohesive with new main exterior signage
- Curved structure to mesh with organic concept
- Simplistic design to read easier and allow building architecture to speak for itself



Main Lobby

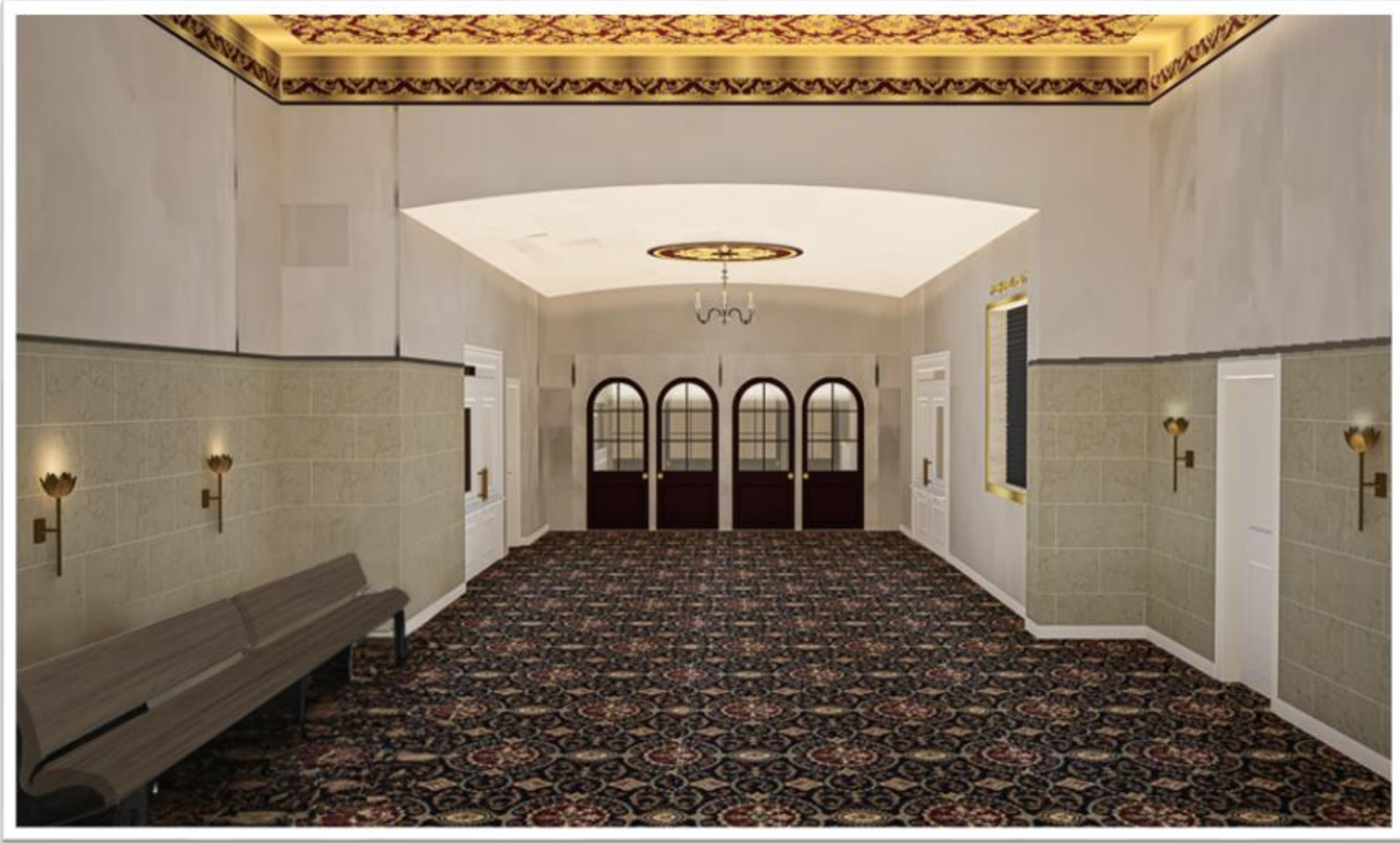
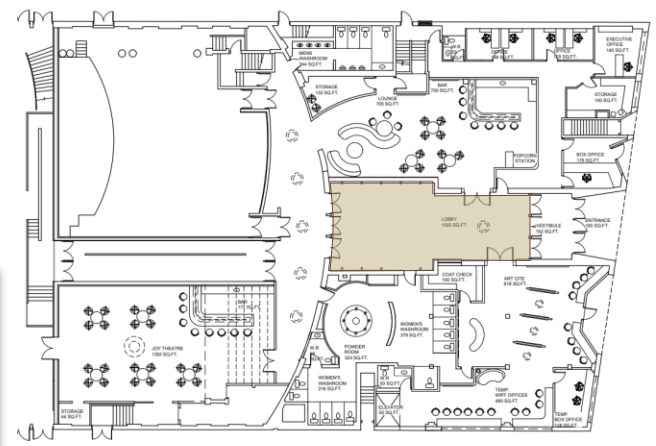

Materials and Lighting

1. Alberto Medium Sconce – Visual Comfort
2. Cottage red – Benjamin Moore
3. Existing carpet flooring
4. Heat Treated Maple wood door – Craftsmen in wood



Bar/Lounge

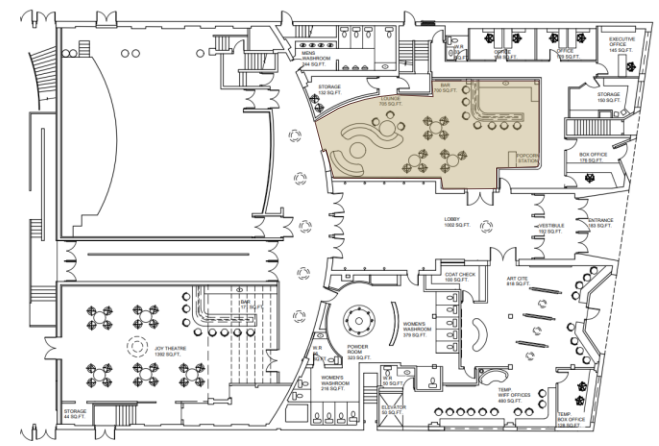

1



7



2

3



4



8



10



11



5



6



9



Materials and Lighting

- | | |
|---|--|
| 1. Moris Bar Chair - Arcedior | 6. Existing carpet flooring |
| 2. Cottage red - Benjamin Moore | 7. Inverness Everleigh - Cambria |
| 3. Essex Green - Benjamin Moore | 8. Green Orelia Floral Wallcovering - Birch Lane |
| 4. Antique English hardware - Richelieu | 9. Aristotle White Rectangle flooring tile - Daltile |
| 5. Kravet smart - bar stool upholstery | 10. Picket Cracked Glass Tile - Tile Bar |
| | 11. Norr11 Studio Curved Chair - Keltur |

Men's Washroom

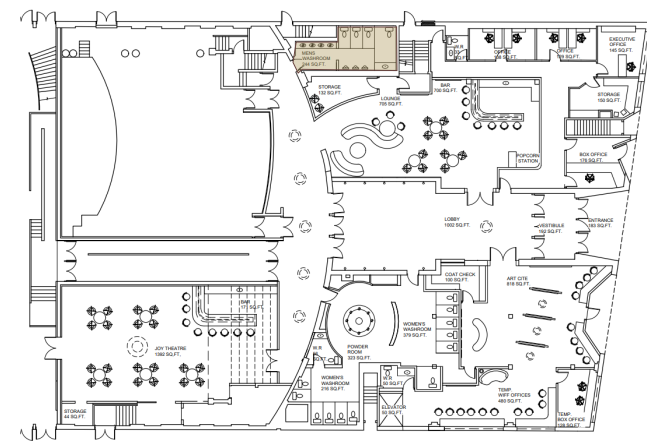
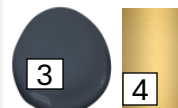
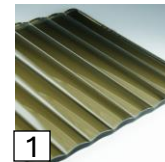

Materials and Lighting

1. Lily Pad Peel and Stick Vinyl Wallcovering - York wallcoverings
2. Cathedral Bronze Architectural Cast Glass - Nathan Allan
3. Brass architectural collection 150 - Michael Anastassiades
4. Hale Navy - Benjamin Moore
5. Gold finishes
6. Cortina - Centura



Art Cite/WIFF offices

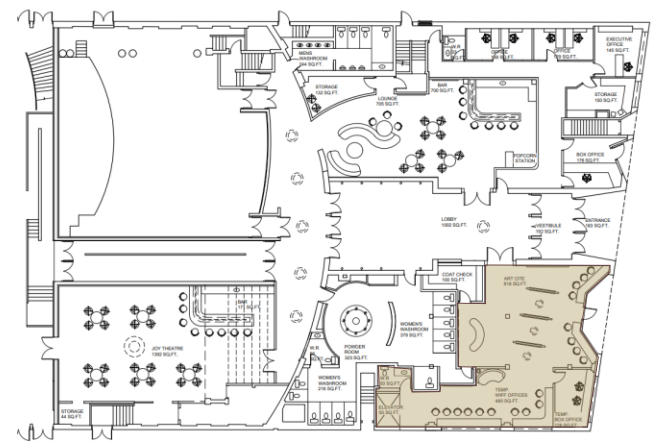

1



2

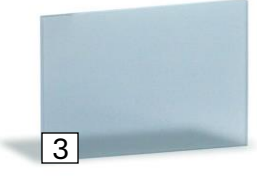

3



4



5



6



7



8

Materials and FFE

- | | |
|--|---|
| 1. Artisan Mela Stool - Vinciguerra | 6. Gold Finishes |
| 2. Wood slats - Andor willow | 7. Hale navy - Benjamin Moore |
| 3. Woven colour resin - Lumicor | 8. Ciara White Java Plain - Prime walls |
| 4. Kravet smart - bar stool upholstery | |
| 5. BIANCO CARARA - Centura | |



Joy Theatre

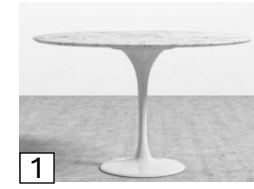
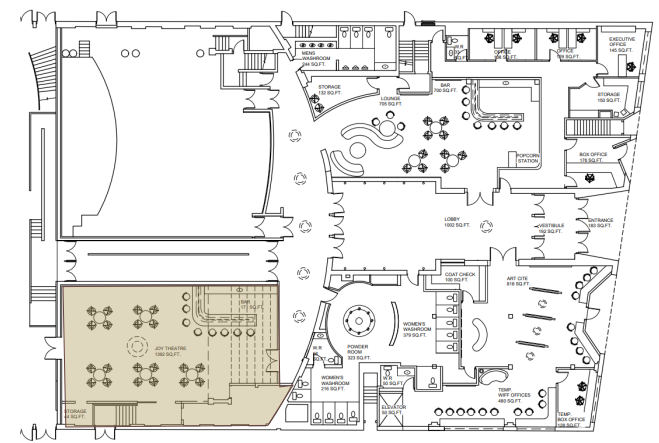

1



2



3

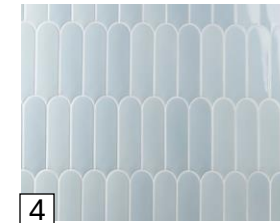

4

Materials and Lighting

1. White carrara marble with natural sealant, Gloss finish - Rove Concepts
2. 8000-Serie chair - Architonic
3. Alberto Medium Sconce – Visual Comfort
4. Parry – Tilebar
5. Inverness bristol bay – Cambria
6. Gold Finishes
7. Ciara White Java Plain – Prime walls
8. Hale navy – Benjamin Moore
9. Cortina – Centura
10. Light Blue Porcelain Tile - Cornerstone



5



6



7



8



9

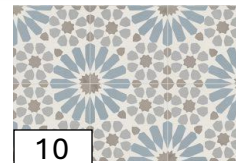

10



WSO offices

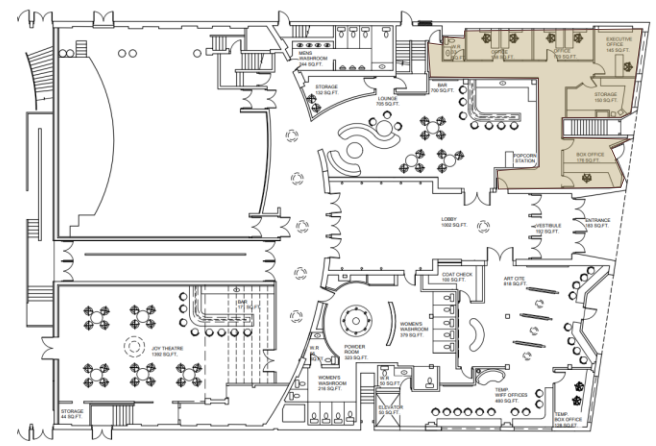

Materials and Lighting

1. Hale Navy – Benjamin Moore
2. Wood slats – Andor willow
3. Cortina – Centura

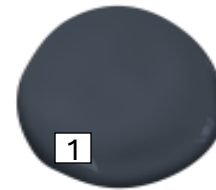

Mood Board - basement

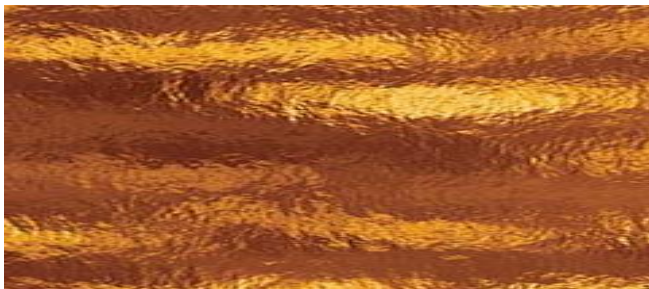
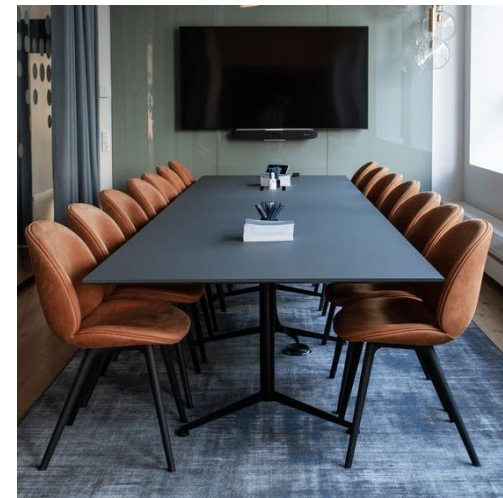
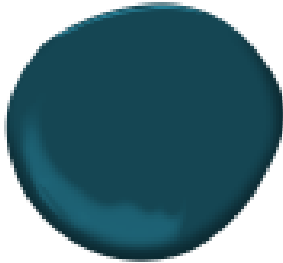

Basement – Furniture Plan

General notes

- Personal office spaces to allow for privacy but boxed off with glass paneling to make the area feel more open and airy.
- Large lounge area with multiple seating types to allow for multiple use including: collaboration, eating, relaxing, working
- Large acoustic paneling drop ceiling implemented to ensure good acoustics as well as a source of general lighting
- Design features a mix of complimentary blue and orange to promote creativity and collaboration as well as calming energy and focus

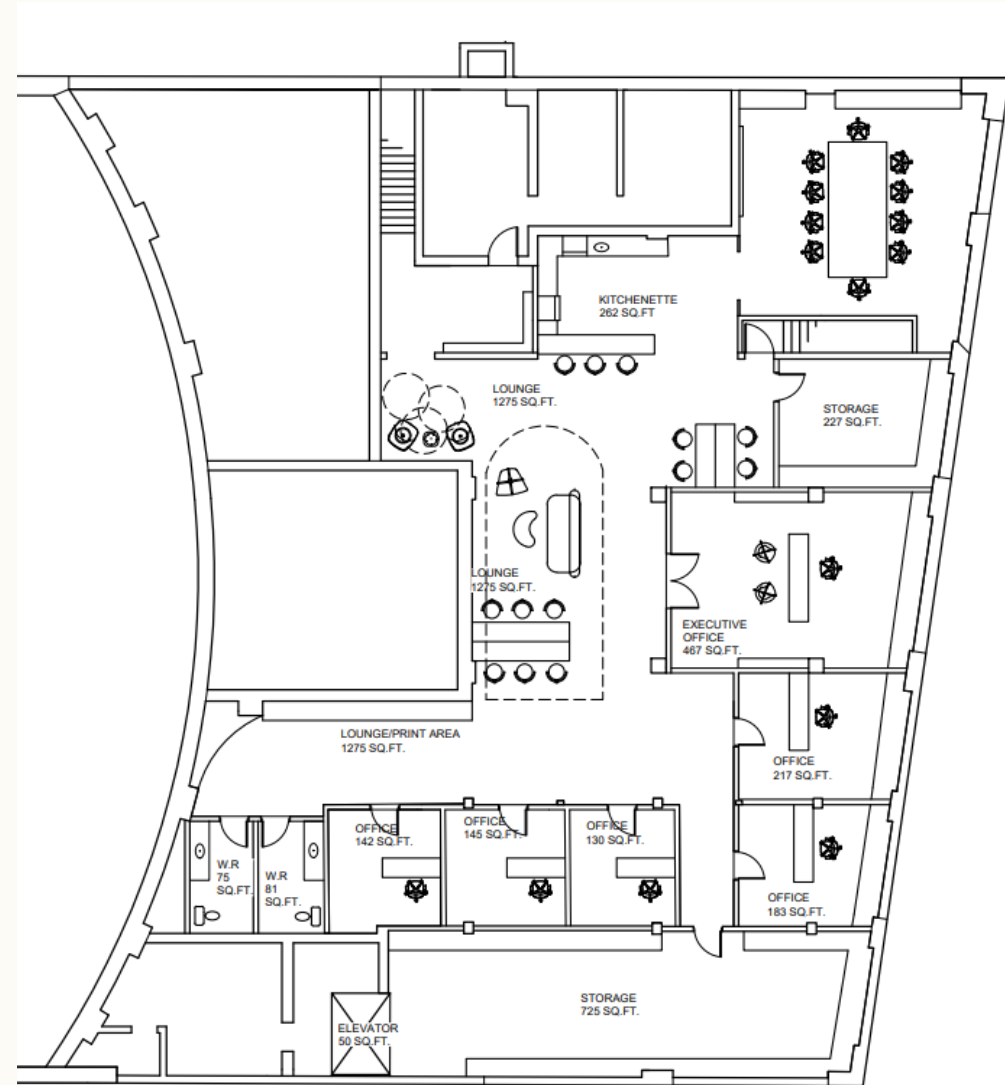

Basement

Materials and FFE

1. Metropolitan chair – Teknion
2. Cortina – Centura
3. Gold finishes
4. Hale navy – Benjamin Moore
5. Tufty Time Sofa – Urban space interiors



2



3

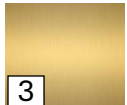

4



5



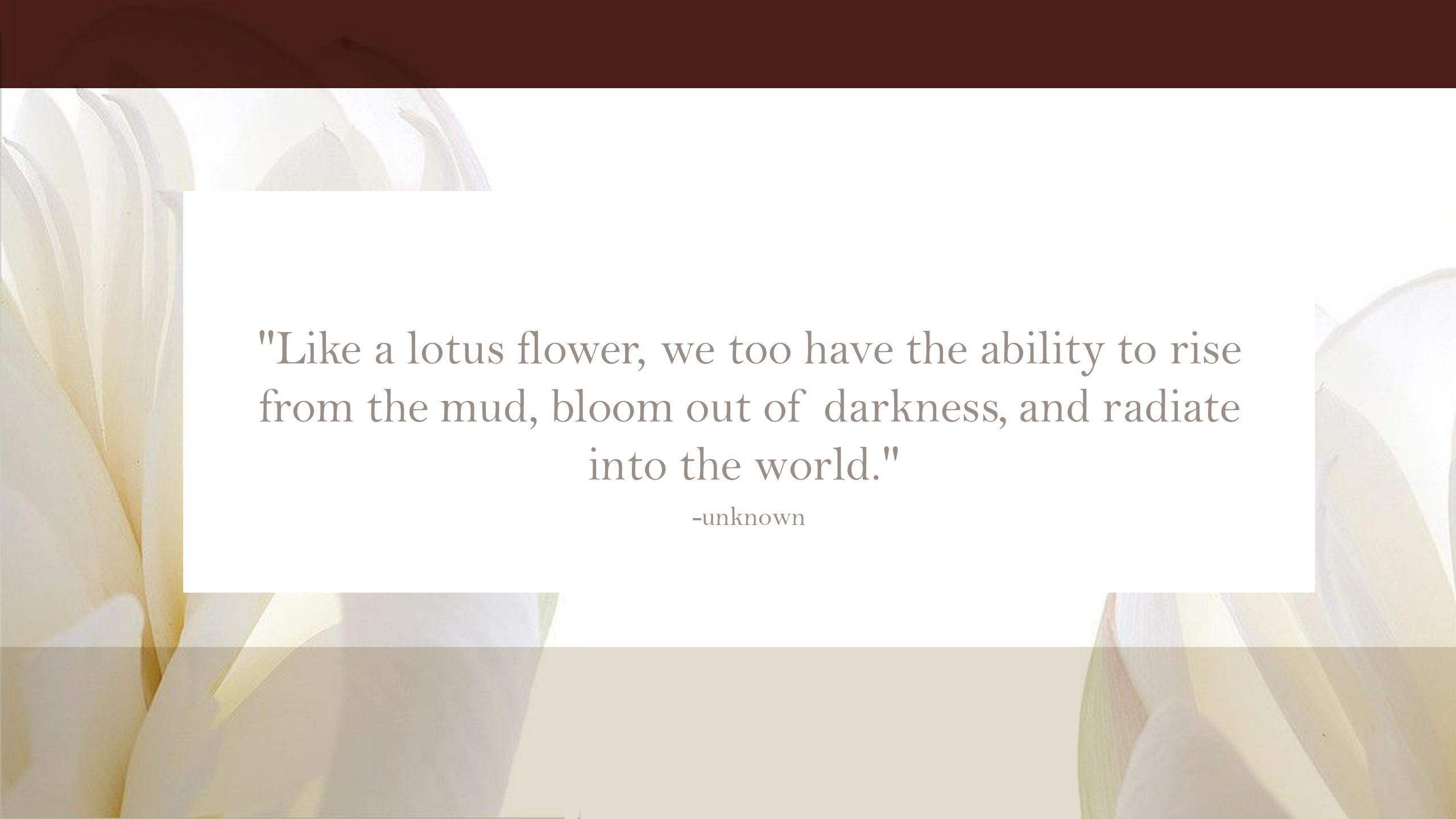

"Like a lotus flower, we too have the ability to rise from the mud, bloom out of darkness, and radiate into the world."

-unknown